

ONIDA

OWNER'S PRIDE

User's Manual

SEMI AUTOMATIC WASHING MACHINE

HYDROCARE SERIES...

MODEL : **HYDROCARE S85GS / S85GS1 / S85GS2 / S85GS3**
HYDROCARE S95GS / S95GS1 / S95GS2 / S95GS3

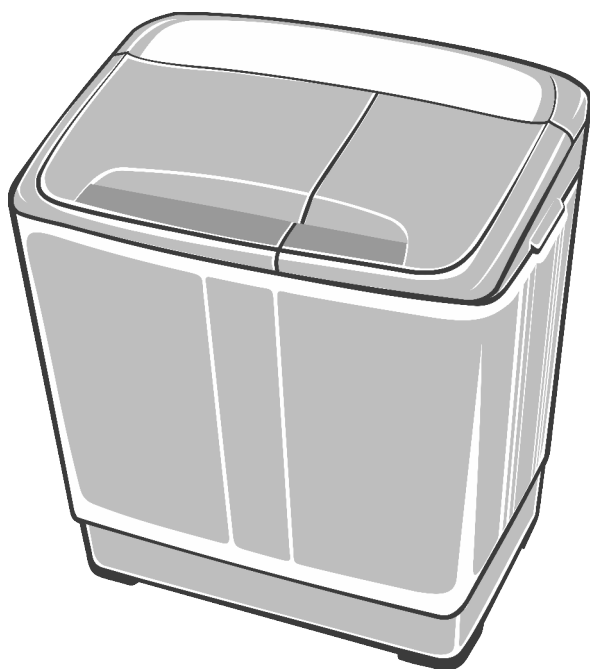

Before operating the Washing Machine, Please read this Guide thoroughly, and retain this manual for future reference.

Contents

	Page No.
Description of Parts	1
Description of Control Panel	2
Safety Precautions	3
How to install	4
How to wash	4
Pre Soak	5
Spin Shower	5
How to Spin	5
Care and Maintenance	6
Trouble Shooting	6
Specification & Wiring Diagram	7
Disposal & RoHS Declaration	8
Warranty Terms & Conditions	9-10



This appliance is not intended for use by persons (including children) with reduced physical, sensory or mental capabilities, or lack of experience and knowledge, unless they have been given supervision or instruction concerning use of the appliance by a person responsible for their safety.
Don't put hands into the tub when it's working.

INTRODUCTIONS OF PARTS

FEATURES IN THIS MACHINE ARE:

● RUST FREE

This machine is made of **Hi Impact Polymer Fiber** which is rust free. This gives your machine a longer life.

● PRE SOAK

Soaking is an important element of the washing process. It enhances and optimizes the detergent's action on the clothes. With this washing machine you can forget about soaking the clothes manually. Just put your clothes in the machine, add water and detergent, the rest will be taken care of by the Unique Auto Soak feature. The Unique Auto Soak option provides you the benefit of an ideal soak, which is better than the manual soak. It supplements soaking with intermittent agitation to ensure that all your clothes receive uniform soaking and better detergent action.

● UNIQUE SPIN FOUNTAIN

When the washed clothes are transferred into the spin tub, there are chances of the detergent still remaining in the clothes. This washing machine has a special inlet in the spin tub through which water is showered onto your clothes. This ensures that any traces of detergent left on the clothes are removed before drying.

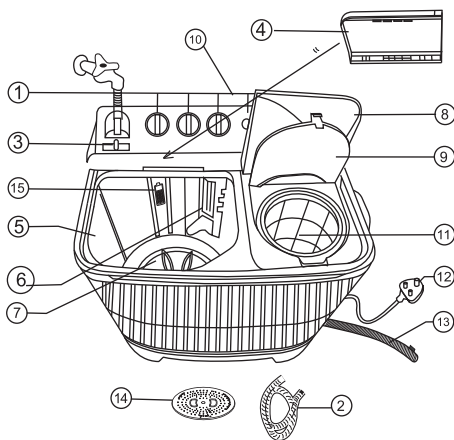

Description of Parts

- | | |
|-----------------------------|-------------------------|
| 1. Control Panel of Machine | 9. Inner Lid |
| 2. Inlet Hose | 10. Drain Hose Hanger |
| 3. Water Inlet Selector | 11. Spinner Tub |
| 4. Wash Tub Lid | 12. Power Cord |
| 5. Wash Tub | 13. Drain Hose |
| 6. Overflow Channel | 14. Spin dry safety lid |
| 7. Pulsator | 15. Magic Filter |
| 8. Spinner Lid | |



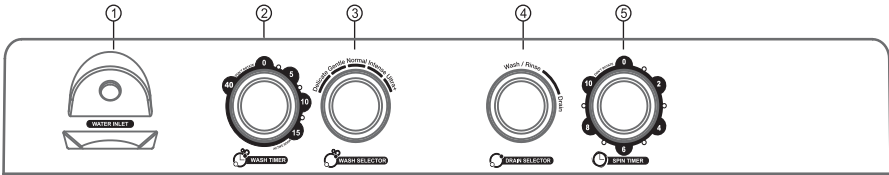

(Please do not match this figure with your machine as it may be different from your model. These are schematic diagrams only).

Parts Identification

CONTROL PANEL



- 1. Water Inlet** : This is used to direct water supply to wash tub for washing or spin tub for spin shower.
- 2. Wash Timer** : This timer is used for Pre SOAK, WASH and RINSE operations. Following combination can be selected.
 A) Pre Soak + Wash :- Select the desire soak time by setting the Timer between 15~40 min.
 B) Wash/Rinse :- You can select any Wash/Rinse time up to 15min. For eg. if you want to Wash/Rinse time for shorter duration turn the knob up to 10min. aposition and turn it back to desired position for normal cycle.
- 3. Wash Selector** : Set the knob to DELICATE, GENTLE, NORMAL, INTENSE, ULTRA+ according to kinds and quantity of the laundry.
 (Number and names of wash Program may differ from model to model)
- 4. Drain Selector** : This selector is to set for "WASH/RINSE" or "DRAIN" the water from wash tub.
 WASH / RINSE for wash & rinse program.
 DRAIN for draining the water from the wash tub.
- 5. Spin Timer** : This timer is used to select your desired length of time to spin laundry by using 10 minutes timer. (if you want to set the timer to 2 min. or less, turn the selector up to the 10min. position, and then turn it back to the desired position.

PROCEDURE FOR SPIN SHOWER RINSE / WATER SAVER RINSE स्पिन शॉवर रिनस (अतिरिक्त खंखालना)/पानी बचत रिनस की विधि		
Spin shower rinse removes remaining detergent from the clothes & can save an additional rinsing and water स्पिन शॉवर रिनस करने से साबुन का पानी कपड़ों से निकल जाएगा, इस रिनस से पानी एवं अतिरिक्त रिनस कि बचत हो सकती है।		
1) Put the laundry evenly into the spin dryer basket. Place the safety cover horizontally on the laundry. कपड़ों को स्पिन टब में फैलाकर डाल दें। सेफ्टी कवर को ऊपर समतल रख दें। <div style="display: flex; justify-content: space-around;">   </div>	2) Make sure SPIN TIMER is at "0" (zero) position (spin tub not rotating). स्पिन टाइमर को '0' पर सेट कर दें। <div style="text-align: center;">  </div>	3) Set water selector to "SPIN". वॉटर सिलेक्टर को स्पिन पर कर दें। <div style="text-align: center;">  </div>
4) Open water tap and allow the water to flow to spin tub about 2 min. नल खोलकर २ मिनट तक पानी स्पिन टब में भरते दें।	5) Turn off the water supply and set the spin timer for 2 min. नल को बंद करें और स्पिन टाइमर को २ मिनट पर निश्चित कर दें।	6) Repeat step 2 to 5 two times. २ से ५ कि क्रिया दो बार दोहराएं।
Note: Please ensure spin tub is not rotating while water is flowing to spin tub. If spin tub is rotating, water will throw all around inside the machine from top of spin cap, without flowing through clothes. Clothes will not get wet & water is wasted without removing detergent in clothes. सूचना: स्पिन टब में पानी भरते समय, स्पिन टब न घुमे ये सुनिश्चित करें। यदि स्पिन टब घूम रहा होगा, पानी स्पिन कवर के ऊपर से, कपड़ों को बिना गिोए मशिन में बह जाएगा, इससे पानी कपड़ों से बिना साबुन निकाले बह जाएगा		

- Note:**
- 1) Do not rotate the knobs more than prescribed limits.
 - 2) Above Graphics is just for representation, it may not match with your machine.
 - 3) Refer Specification chart.

Safety Precautions

Do not use Washing Machine to wash items other than Clothes, Blankets, Curtains, Towels, etc.

Never disassemble, Repair or Remodel this washing machine. This can cause fire or irregular action that may Result in injury.

Consult Brand Service Desk Mentioned on Warranty Terms & Conditions page

- Install the washing machine on a sturdy floor levelled across corners

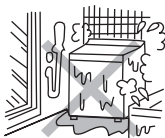

- If machine is installed on Carpet, be sure that Carpet does not block any openings.

- Do not place flammable substances near the machine such as Kerosene, Benzine, Paint Thinner and Alcohol. Do not put clothing with such substances in the tub. There is a risk of Explosion or Fire.



- When spinning always use the spinning cap pressing tightly against the clothes, maintain the horizontal level.
- Do not use water hotter than 40° C for washing clothes.

- It is recommended to drain all the water from wash tub if any, after completion of your wash cycle.

- Never touch laundry with your hand during the spin cycle until the tub has completely stopped spinning.



- If you touch the laundry, even if the tub is rotating slowly, there is a danger of injury if your hand becomes entangled with the laundry. pay particular attention to protecting children from such injury.

- When the washing machine gets dirty, wipe it with the slightly wet cloth.

- Do not use machine when power cord is torn or damage Removing the power plug from the power outlet, you should remove it by pulling its plug insulated body, not its cord; and do not place the machine or any heavy objects on the power cord; it may cause the damage to the power cord. If the plug of power cord is damaged, contact your brand authorised service desk (details in last page).



Please do not put your hands under the machine, as there is a rotating mechanism.



NOTE :

"This appliance is not intended for use by persons (including children) with reduced physical, sensory or mental capabilities, or lack of experience and knowledge, unless they have been given supervision or instruction concerning use of the appliance by a person responsible for their safety. Children should be supervised to ensure that they do not play with the appliance."

How to Install

- 1) Install the Washing machine in a well-ventilated, safe place. Machine should be put on flat ground and where can you connect the power supply. It is recommended to place the washing machine on a leveled floor and avoid a place where the washing machine can be exposed to direct sunlight.
- 2) Insert the power plug firmly into the main power supply.
- 3) Water supply in the inlet hose can be adjusted to Wash Tub or Spin Tub.
- 4) The feeding water indicator.

When the water spills out of the hole above the label, it means too much water has been supplied. Adjust the water tap.

- 5) Pull out the drain hose from the washing machine. When using the machine for the first time, you may find water remaining in the drain hose. It was used for the factory performance test. It does not imply any malfunction.

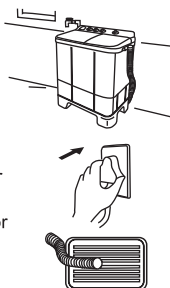

Preparation for Washing

1. The machine should be put on Flat Ground.
2. Ensure Three Core Power Plug seat must have Ground Connection.
3. Lay down the Drain Hose.
4. Connect the water Inlet Hose to Water Tap.
5. **Remove objects like coins, pins, foreign particles, etc., from clothes before washing. They may damage your clothes and clog drain system.**
6. According to the weight of cloth, adjust the level of water.
7. Switch ON power.

How to Wash

1. Set the knob to "WASH / RINSE".
2. Fill the tub with water according to the weight of the cloth (Refer table 1).
3. Put the clothes in the tub. Do not put an excessive amount of laundry, in the tub (Refer table 1).
4. Put recommendable quantity of detergent as mentioned in Table 1.
5. Set the Wash Selector to DELICATE, GENTLE, NORMAL, INTENSE, ULTRA+ mode as you desired.
6. Set Wash Time up to 15min, depending on your cloth load & type.
For Auto Soaking, set time between 15~40min.
7. When washing is completed, drain off the washing water by adjusting the knob to "DRAIN" position.
8. After the washing water is discharged, turn the knob switch to "WASH /RINSE" position.
9. Fill the water up to the desired level for rinsing.

Note: Water level may be less than the water level line while washing. If so, refill the water. Be careful not to exceed the indicated water level line, it may cause water to spill out of the tub.

Table 1: Detergent Guide

WASH LOAD	1.2~2.5 Kg	2.5~3.8 Kg	3.8~5.0 Kg	5.0 Kg or ABOVE
Water Level	LOW	Medium	High	Over Flow
Amount of Detergent	40 gm	50 gm	60 gm	64 gm
Amount of concentrate Detergent	25 gm	30 gm	38 gm	40 gm
Amount of Softener	22 ml	26 ml	29 ml	35 ml

- Note: 1) Actual quantities of load may vary depending on the material size of laundry items & hence suggested quantities here are indicative for reference only.
- 2) If movement of cloth is too slow, remove some of the cloth until a steady movement is observed.
 - 3) Water Droplets may be seen inside the tub or the outer body when unpacked at customer end; This is neither a Machine Malfunction nor Product has been used earlier.

RINSING :

1. Fill the water up to desired level depending on cloth load.
2. Set WASH TIMER to 5 ~ 15 min. position to RINSE.
3. When you finish rinsing, drain off the water from the tub by turning the knob to "DRAIN" position.
Transfer clothes to Spin Tub for Spinning.

Pre Soak

SOAKING FUNCTION :-





SOAK Function enhances the efficiency of the regular function, which helps to wash the clothes cleaner. Soak function will be operated after the WASH TIMER switch is set to 40 min position, then the machine will operate with soak function. Soak function will run and stop alternately until the 15th minute then the operation will resume to regular function. To set time for regular wash or soak function, turn the knob to your desired period of time.

Spin Shower Rinsing

With spin shower, the remaining detergent in the clothes will be removed and you can save on additional rinsing time and water. (However, if water from the tap contains rust and / or dirt, do not perform spin shower.)

1. Direct water to spin tub by turning knob / lever.
2. While SPIN TIMER is at "0" (zero) position (spin tub not rotating), turn on the tap for about 1 minute.
3. Turn OFF the tap and then spin for about 2~10 minutes.

How to Spin

-  Put the laundry into the spinner tub by putting the small-sized laundry in the bottom area to keep the balance of the tub. (figure 1)
-  Place the SPINNER CAP in the tub as shown in the figure 2.
-  Close firmly the inner and outer lids of the spinner tub.
-  Select the spin time to 2 -10min.

Your Washing Machine is star rated as per the energy star label pasted on the Product

For Energy efficiency instruction:-

Bee Star label Machine: ENERGY SAVING WASH METHOD FOR RATED LOAD is as below

Wash Selector: GENTLE (for 2 Program models having GENTLE and HEAVY)

: GENTLE (for 3 program models having GENTLE, NORMAL & STRONG)

Wash Method :

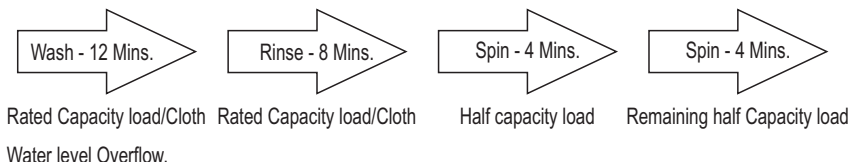

SPINNING TIME FOR LAUNDRY

1. Cotton clothes :10min.
2. Delicate clothes (Thin synthetic fiber, sarees etc.): 2 min.
3. Sweater (Synthetic fiber) : 2 ~ 3 min.
4. Underwear (Knitting clothes) : 3 ~ 5 min.
5. Heavy Clothes (Bed Sheet, Towel etc.) :10min.

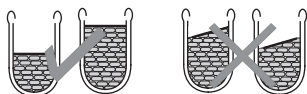

Fig. 1

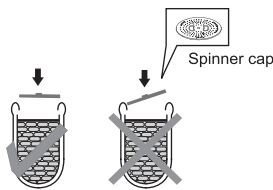

Fig. 2

HINTS FOR SPINNING

- ✎ If there is a sound from the spinner, open the spinner lid then try to distribute the laundry evenly.
- ✎ If the lid is open while the spinning function is working, the machine will stop within 5 ~ 10 seconds. If it is still running, contact Brand service desk.

Care and Maintenance

Be sure to remove the power plug from main power supply before cleaning the machine and filter

A) Cleaning MAGIC FILTER

1. Push the upper part of the Magic filter and pull in.



2. Open the cover as shown in figure



3. Clean the Magic Filter



4. Close the cover and insert the lower 'A' part of the filter in the basket first and push the filter from upper part 'B' with "click" sound.



Note: It is recommended to clean the Magic Filter regularly.

Cleaning the Wash Tub

1. After washing is complete, fill fresh water above the level of pulsator without adding clothes.
2. Run the machine for 1~2 minutes turn the knob to "DRAIN" position when pulsator is still rotating.
3. When water is completely drained out, turn the knob to "WASH/RINSE" position.
4. Finally turn off the machine.

Trouble Shooting

IF ANY ABNORMALITY IS FOUND, CHECK THE FOLLOWING BEFORE CONTACTING SERVICE HELPLINE DESK

TROUBLE	CHECKPOINT
The washing machine does not work.	<ul style="list-style-type: none"> • Is the power supply cord connected to a power outlet? • Is there power cut? • Is the pulsator tangled with something?
Unable to drain	<ul style="list-style-type: none"> • Has the Drain Hose been lowered? • Is the Drain Hose blocked? • Is the Drain Hose kinked?
Abnormal sound during wash.	<ul style="list-style-type: none"> • Are there any loose articles in the Wash Tub?
Incomplete spinning (Severe vibration or unbalance)	<ul style="list-style-type: none"> • Are the laundry arranged evenly? • Is the machine being placed on a flat and solid ground? • Are there any clothes dangling on the Spin Tub? • Are there too many laundry in the Spin Tub? <p>See "Spinning.." on page 5</p>

SPECIFICATION

Model	S85GS / S85GS1 / S85GS2	S95GS / S95GS1 / S95GS2	S85GS3	S95GS3
Max. Rated Capacity Wash	8.5 kg	9.5 kg	8.5 kg	9.5 kg
Max. Rated Capacity Spin	6.0 kg	6.0 kg	6.0 kg	6.0 kg
Power Supply	230V AC / 50Hz	230V AC / 50Hz	230V AC / 50Hz	230V AC / 50Hz
Washing Input	480 W	530 W	480 W	530 W
Spinning Input	180 W	180 W	180 W	180 W
Water Capacity High	82 L	82 L	82 L	82 L
Water Capacity Low	65 L	65 L	65 L	65 L
Wash Timer	40 min.	40 min.	35 min	35 min
Spin Timer	10 min.	10 min.	5 min	5 min
Net weight (approx.)	25.7kg	26.0kg	23.7 kg	24.0 kg
Machine dimensions	830x495x1010mm	830x495x1060mm	830x495x1010mm	830x495x1060mm

WIRING DIAGRAM

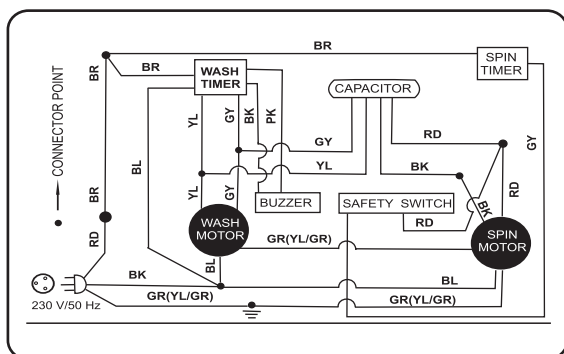

PACKING LIST

Name	Quantity
Semi Automatic washing machine	1
Spin-dry safety lid	1
Inlet pipe	1
User manual	1

E-Waste Management



Compliance with E-waste Management Rules :

As per the Government of India's **E- Waste (Management) Rules, 2022)**

Gazette: G.S.R 801(E) 02/11/2022 (**As amended from time to time**)

under Environment protection Act 1986/29 end of life products intended to be discarded should be channelized for dismantling and recycling through authorized dismantler and recycler only to ensure environmentally sound management of E waste. This product bears a classification symbol for waste electrical and electronic equipment (WEEE). This product has been manufactured with parts and material that can be reused and are suitable for recycling. Do not dispose of the product with normal domestic and other wastes at the end of life. To facilitate return of End of Life product, visit our website www.onida.com for details or contact nearest authorized service center.

RoHS
COMPLIANT

WARRANTY

Standard Warranty period

2 years
2 years

For S85GS, S85GS1, S95GS, S95GS1
For S85GS2, S95GS2, S85GS3, S95GS3

Warranty Period (applicable only on the parts mentioned below)

5 years (only on wash motor)
10 years (only on wash motor)

Customer Privileges.

1. The warranty is confirmed only to the first purchase of the appliance and is non-transferable. This warranty card and purchase bill shall be presented to our staff at the time of service and the warranty shall be void if the warranty card is altered/tampered with or lost.
2. The warranty period (both standard Warranty Period and Extended Warranty Period) starts from the date of purchase of the appliance and shall be available to products installed within municipal limits.
3. The warranty covers only manufacturing defect in material that may arise despite normal operation and usage of the appliance in accordance with the user manual.
4. Repairs, installations & removal of the appliance shall be got carried out only by an Authorized Service Personnel, failing which warranty will be void.
5. In the event of change of address and contact details, the new address and the new contact details shall be intimated to the Authorised Service Center on the given toll free number for ensuring proper installation, Charges shall be applicable and borne and paid by customer.
6. Repairs &/or replacement of parts covered under warranty would be purely at the sole discretion of the Company & Authorised Service centre Head only.
7. In the event of a part covered under warranty / wash motor required to be repaired then our person's obligation will be to repair such part/ wash motor to restore the product to working condition.
8. The company's obligation in respect of parts covered under warranty in event where repair is not possible shall be to provide replacement of defective parts with a functionally working part / wash motor of any brand/make.
9. It is hereby clarified that on expiry of Standard Warranty Period, visiting charges will be applicable for all visits and the same will be borne by the customer. In the Extended warranty period, in case the product needs to be transported to the Authorised Service Center for repair, the transportation charges from and to the place of installation shall be borne and paid by the customer.
10. The customer shall provide a reasonable, sufficient and safe working space to access the appliance for service. The customer is liable to move away all blocking objects or move the appliance to an appropriate location with electricity /gas/water supply and drainage for testing of the appliance.
11. In case of appliance requires to be repaired at service centre, all expenses incurred in transportation of the appliance or parts thereof from and to the company's Authorised Service Center, as well as expenses incurred on deputing of service personnel/technician towards conveyance, inspection and other incidental expenses, will borne and paid by the customer.
12. In case of repairs the replaced spare part will be warranted only for the unexpired period of the warranty.
13. The company shall be under no obligation or deemed to be in default or liable for cost , compensation , damage, penalty , fine, or otherwise on account of delay or failure in performance resulting from causes beyond its reasonable control (e.g. strikes, floods, earthquakes etc.) including but not limited to delay in servicing due to non-availability of spare parts and/or accessories.
14. The defective part shall belong to the company.
15. Warranty issued is subject to purchase from authorized dealers and repair by company's authorized service centre only .
16. Dispute if any in respect of Warranty shall be subject to exclusive jurisdiction of Mumbai court irrespective of the point of sale

Warranty is not applicable in any of the following cases:

1. If the warranty card is not duly filled and does not bear the stamp, date and signature of the authorized Dealer.
2. The warranty does not cover any consequential or resulting liability, damage or loss to property or life arising directly or indirectly as a result of appliance failure, breakdown, or accident or usage of the Appliance not in accordance with the operating / user manual.
3. Warranty is not applicable on plastic parts , electrical parts ,top, lid, assembly, control panel , window, knobs, nut , bolts, drain pipe, cabinet, dispenser assembly, drain hose, filter, castors, wheels, foot, drum , body of the washing machine and washer .The warranty does not cover consumables, normal wear & tear parts, plastic, glass and/or rubber parts, operational parts and accessories.
4. If the Appliance has been subjected to improper use such as operated on trolley other than the one, if any purchased from the Company, use contrary to user manual, misused, abused, not cared for, abnormal use, use of sea water, sub-standard detergent, exposure to dampness, excessive heat, excessive humidity and other extreme environmental conditions, corrosion, damage beyond repair, rusting, unauthorised modifications, unauthorized repairs, neglect, accident, damage in transit, alteration, acts of God, spillage of liquid or food particles, faulty electric wiring/cabling, abnormal voltage/power supply beyond appliance specifications, damage/breakage/non-functioning of appliance due to rodents, rats, cockroaches and ants etc.
5. The warranty does not cover preventive checks, routine maintenance, cleaning, de-scaling and overhaul and charges shall be borne and paid by Customer.
6. If the Appliance is used by commercial establishment including but not limited to hospitals, saloon, institutions, laundry, community hall and other similar establishment or by an individual/ firm for commercial purpose.
7. If the warranty card, bill of purchase, serial number of appliance is removed, altered, defaced, made illegal/tampered with. No Person including the customer, dealer, service personal shall have the right to vary the terms of this warranty.
8. If incorrect/not suitable detergents are used for laundry appliances.
9. If repair, installation work is carried out by persons other than Authorised Service Personnel.
10. Damage to the appliance or any part(s) due to transportation or shifting or arising out of improper storage of the appliance at the Customer's premises.

WARRANTY CARD

Machine Sl. No.: _____	<div>Stamp of Dealer</div>
Model : _____	
Dealer's Name : _____	
Address : _____	
Date of Purchase : _____	
Date of Expiry : _____	

* CONDITIONS APPLY AS DESCRIBED IN MANUAL

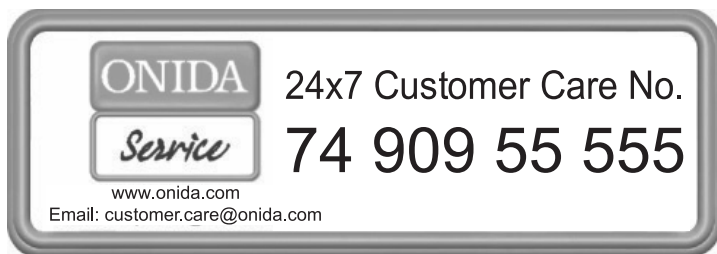

MARKETED BY :
MIRC ELECTRONICS LIMITED
ONIDA HOUSE, G-1, MIDC, MAHAKALI CAVES ROAD,
ANDHERI (EAST), MUMBAI 400 093
MADE IN INDIA
www.onida.com